

Sorting and putting out garbage and recyclables

* Please refer to the “Garbage/Resources Collection Calendar” for the garbage pick-up days.

1. Separate garbage.
2. Place garbage in designated pickup locations.
3. Set garbage out by 8:00 a.m. on designated pickup days.

Recyclable items

* Containers and packaging that were used to contain or wrap products.

Plastics to recycle

[Collected four times a month]
Items made entirely of plastic no longer than 50 cm in length on any side

Empty cans

[Collected twice a month]
Food packaging

Empty bottles

[Collected twice a month]
Food and cosmetics bottles

PET bottles

[Rules differ according to area.]

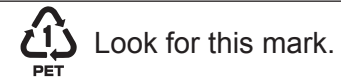

Look for this mark.

Paper

[Collected once a month]

Newspapers



• Bundle newspapers and flyers together.

Cardboard boxes

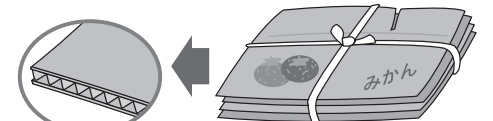

• Cardboard has a corrugated filler that can be seen from the side.

Rinse clean and shake dry before setting them out for recycling.

① Plastic containers and packaging*

Containers and packaging made of plastic, polyethylene, vinyl

Bottles

Detergent, shampoo, cooking oil, etc.

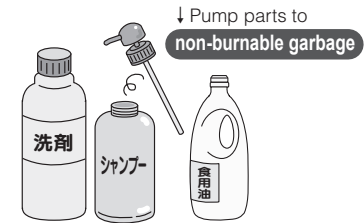

Trays and packages

Egg packs, food trays, etc.

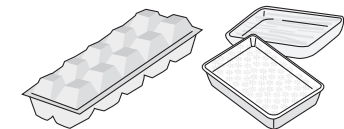

Packages and packaging material
Styrofoam for electric appliances, cushioning sheets, etc.

Cups

Cups, pudding cups, etc.

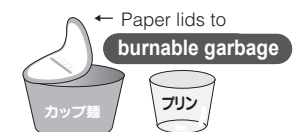

Polyethylene bags and film wrap

Plastic wrap from trays, packaging films from candy boxes, etc.



Cans that contained juice, beer, food, etc.

Beer cans up to 3 liter in size are accepted.

↓ Separate pull-off tops as
non-burnable garbage



Do not crush.
Place directly in collection bin.

Bottles that contained beverages, seasoning, cosmetics (excluding smoked glass), etc.

Colorless | Brown | Other

* Remove detachable caps.

Separate as **non-burnable garbage** or **plastics to recycle**.

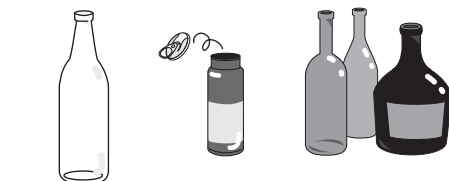

Separate by color into baskets.

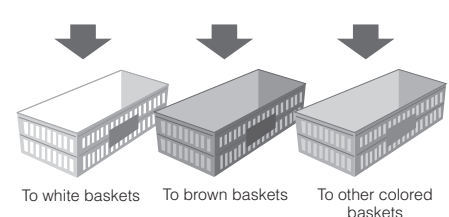

PET bottles that contained soft drinks, soy sauce, sake, mirin, etc.

Remove caps and labels and recycle them as

plastics to recycle.

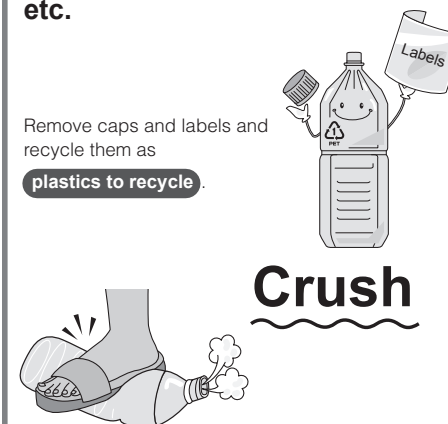

People living in Toyama and Fuchu should bring their PET bottles to supermarkets and other participating collection centers.
People living in Osawano, Oyama, Yatsuo, Yamada and Hosoiri should place their PET bottles in designated pickup locations.

Place directly in collection bins without enclosing in plastic bags.

Separate cans and glass bottles with stubborn dirt as **non-burnable garbage**.

It is not necessary to separate aluminum and steel cans.

Separate broken bottles and medicine bottles as **non-burnable garbage**.

Separate plastic bottles, containers and packaging with stubborn dirt as **burnable garbage**.

Separate the garbage below as **burnable garbage**

- Paper that has waterproofing or uses gold or silver leaf (paper cups, yogurt lids and containers)
- Non-woven fabrics such as face masks and hand towels
- Shredded paper, sticky labels, and pressure-sealed postcards
- Receipts (thermal paper), carbon paper, carbonless paper, photographs, etc.

Practice the 3 Rs!

Reduce: Reduce garbage by not buying or accepting unnecessary items.

Reuse: Reuse what can still be used.

Recycle: Properly separate garbage so that contained resources can be recycled.

Place items of ① and ② above together into a clear or semitransparent bag.

- Items that are longer than 50 cm go into **burnable garbage**.
- Items that cannot be cleaned go into **burnable garbage**. Anything that includes metal goes into **non-burnable garbage**.
- Never put lithium-ion batteries or lighters into the bag, as they can cause a fire.

Inquiries

Regarding separating garbage

Toyama City Waste Management Section
7-38 Shinsakuramachi, Toyama-shi
443-2281 haikibutsu-01@city.toyama.lg.jp

Regarding collection

Toyama-shi Kankyo (Environment) Center
637 Kuriyama, Toyama-shi
Administration Section 429-7366
kksentagyomu-01@city.toyama.lg.jp
Management Section 429-5017
kksentakanri-01@city.toyama.lg.jp

Burnable garbage [Collected twice a week]

Please put the garbage in clear or semitransparent bags and tie the bags tightly before putting them out for disposal.

⇒ Items which are too large to fit into bags should be left as they are and placed in the disposal area together with other such items.

• Kitchen garbage

Drain wet garbage thoroughly.



凝固剤

Cooking oil

Solidify oil with a coagulant or soak up with cloth or paper.

- Rubber products
- Leather goods
- Paper diapers (remove all traces of excrement)
- Disposable heating pads
- Cooling materials

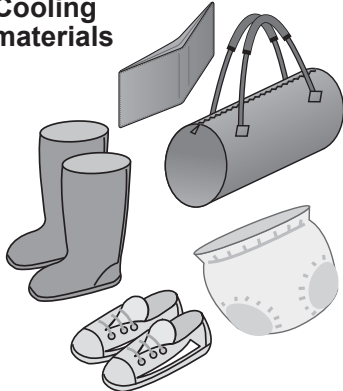

- Charcoal
- Fireworks
- Matches
- Shells



Wet fireworks or matches with water before putting out for collection.

Be careful how you prepare the following.

Keep garbage less than 1 m in any one direction.

• Wooden furniture

Cut into pieces and tie into bundles no larger than one meter.

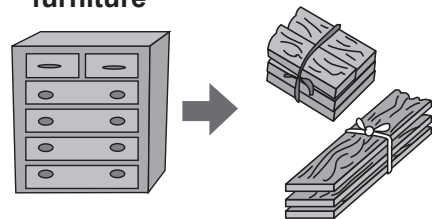

- Futons
- Carpets
- Clothing
- Cloth



Keep carpeting to one meter in length and bind with string.

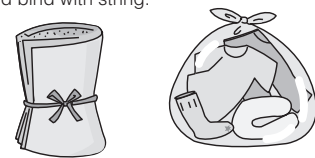

• Mattresses and sofas without springs

Tie into bundles no larger than one meter.

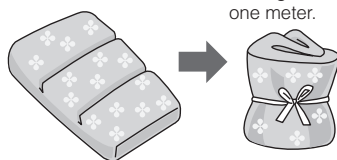

- Grass
- Leaves
- Branches



Label branches with thorns. Bundle loose branches, and set out 2 - 3 bundles each pickup day.



Keep bundles less than 10 cm in diameter.

Dry leaves, remove dirt and place in plastic bags.

Please dispose of large amounts of garbage by dividing them into small lots and disposing them over a period of several garbage days. Liquids are not collected.

Non-burnable garbage [Collected twice a month]

- Small electric appliances (Items not covered by the Home Appliance Recycling Law)

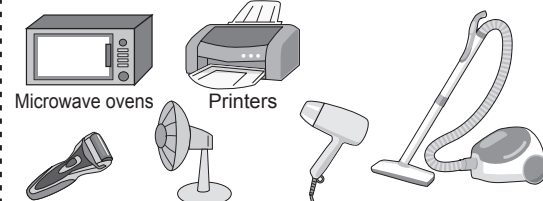

• Batteries

Take button batteries and rechargeable batteries to a store that collects them!

Button batteries are marked "SR," "PR," or "LR" depending on their shape. Rechargeable batteries have one of the recycle marks shown here.



Ni-Cd batteries



Ni-MH batteries



Li-ion batteries

Cover the (+) and (-) electrodes with tape before putting out for disposal.

• Bicycles

Label as "ごみ・不要 (Garbage)"



- Metallic items or items that contain metal

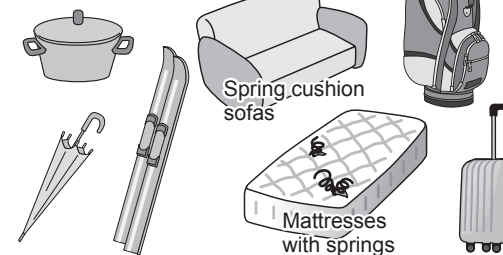

Another truck will pick up bicycles and other large or heavy items later, so set them apart from other garbage.

Be careful how you prepare the following.

To prevent injury to garbage collectors and fires on trucks, prepare garbage as follows.

- Oil stoves
- Fan heaters

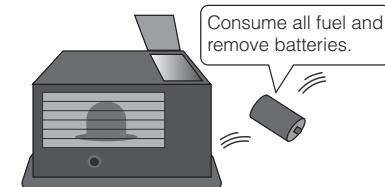

Heaters are not collected if still containing fuel. Remaining fuel can ignite and burn.

- Gas ranges

Remove batteries.

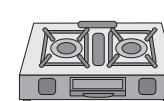

- Portable burners

Remove gas canisters.



- Gas canisters
- Spray cans
- Lighters



After completely using all of the contents, do not make a hole in the can. Put only those cans in a clear plastic bag.

- Glass (Medicine bottles, mirrors, cups, plate glass, heat-resistant glass)
- Ceramics (plates, bowls, flowerpots, etc.)
- Sharp edged items



Wrap the broken pieces or sharp edged items (knives, blades, broken glass, etc.) with paper and write down "注意" (Caution!) on the outside.

How to read the Garbage/Resources Collection Calendar

Calendar abbreviations

Sunday	➡	「 日 」
Monday	➡	「 月 」
Tuesday	➡	「 火 」
Wednesday	➡	「 水 」
Thursday	➡	「 木 」
Friday	➡	「 金 」
Saturday	➡	「 土 」

Burnable garbage	➡
Non-burnable garbage	➡
Empty cans	➡
Empty bottles	➡
Plastics to recycle	➡
PET bottles	➡
Paper	➡

Calendar abbreviations

「 可燃 」
「 不燃 」
「 缶 」
「 びん 」
「 プラ 」
「 ペット 」
「 紙 」

Unaccepted garbage

- Hazardous, explosive or flammable items
- Items that the city cannot process

- Tires
- Storage/automobile batteries
- Motorcycles
- Fire extinguishers
- Gas cylinders
- Farming equipment and tools
- Agrochemicals
- Agricultural plastics
- Petroleum
- Medical syringes
- Paints
- Computers

For disposal information, contact the place of purchase or a licensed waste handler.

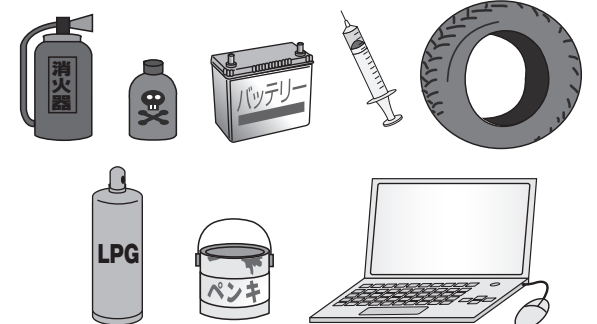

- Soil
- Sand
- Rocks
- Roof tiles
- Bricks
- Concrete (Blocks, laundry pole bases, etc.)
- Plasterboards

For disposal information, contact the place of purchase, a licensed waste handler or the Administration Section, Environment Center.

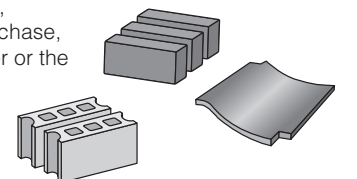

TVs, air conditioners, refrigerators (freezers), washing machines and clothes dryers (Appliances accepted under the Home Appliance Recycling Law)

Purchase a recycle sticker at the post office and do either of the following.

- [1] Bring the item to a designated drop-off site.
- [2] Apply for home pickup by the Environment Center. (Subject to a separate surcharge.)

Or, ask a home appliance dealer.

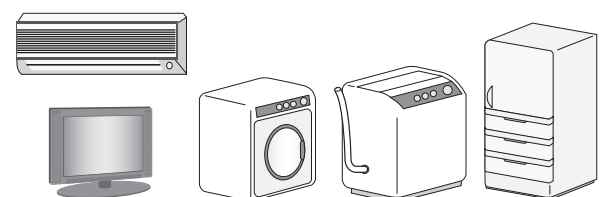

WARNING!

Collectors will label and leave unacceptable items.

